



**Alex & Matteo**  
ESTATE AGENTS



## Blondin Way, London, SE16 6BF

**\*\*UNFURNISHED\*\***

This well-presented apartment features a bright and spacious reception room that opens onto a private balcony, perfect for relaxing or entertaining. The modern kitchen offers ample storage and sleek finishes, while the generous double bedroom includes a built-in wardrobe for convenient storage. A contemporary bathroom and additional hallway storage complete the interior.

Set within a well-maintained, modern portered development, the property benefits from a peaceful yet connected location. Residents can enjoy direct access to the nearby ecological park, a beautiful green space offering walking trails, wildlife, and a welcome escape from city life. Local shops, cafés, and amenities are just moments away, and excellent transport links are within easy walking distance ideal for commuting or exploring the wider area. The exciting Canada Water Masterplan development is also just minutes away, adding even more appeal to this vibrant and evolving neighbourhood.

- Spacious One Bedroom Apartment
- Plenty of Storage
- Private Balcony
- Concierge
- Unfurnished

**Alex & Matteo**  
ESTATE AGENTS

**£1,850 Per month**



# Blondin Way, London SE16

Approximate Area = 567 sq ft / 52.6 sq m

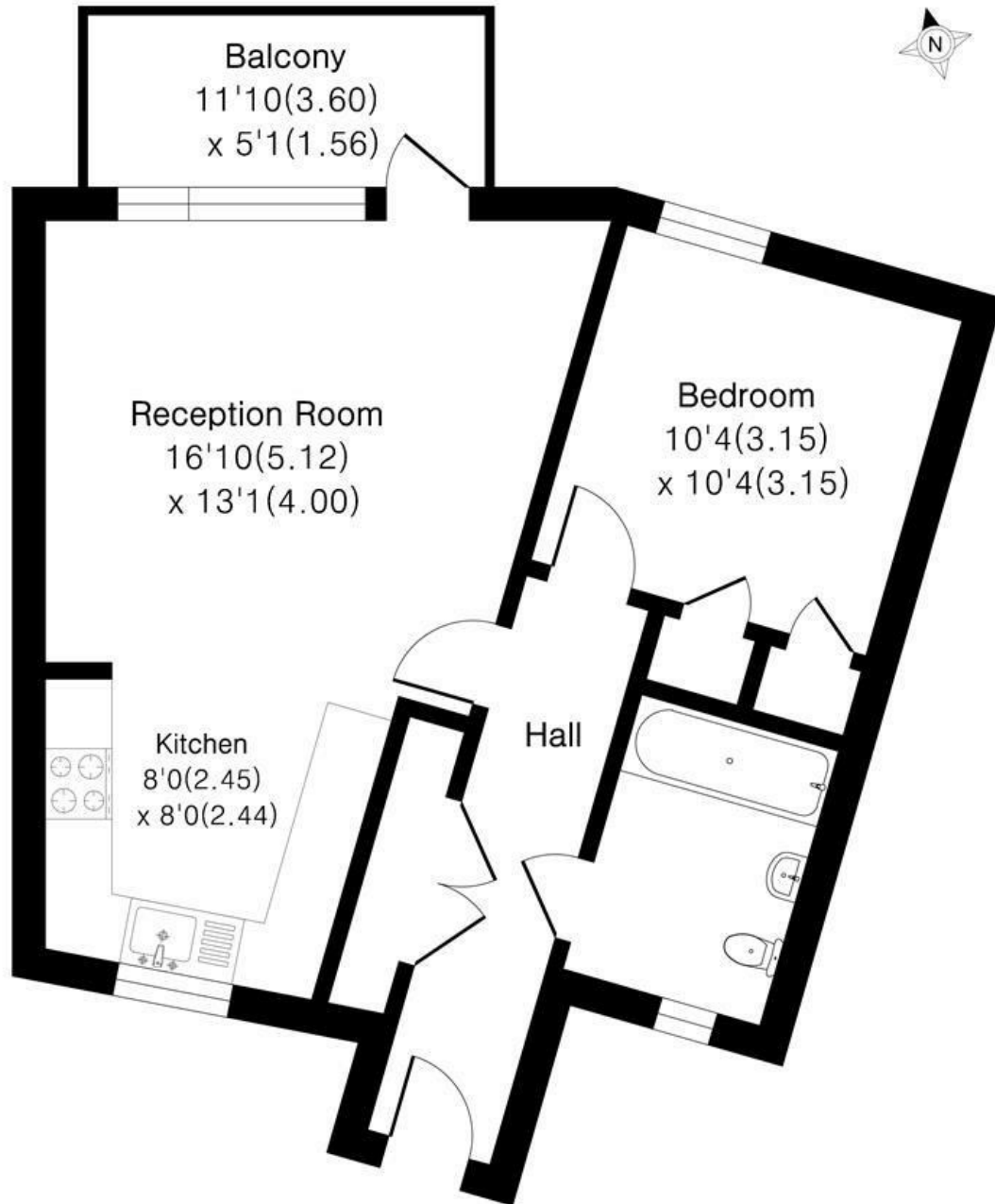

Floor plan Produced in accordance with RICS Property Measurement 2nd Edition.  
Incorporating International Property Measurement Standards (IPMS2 Residential).  
Produced for Alex & Matteo Estate Agents.

Energy Efficiency Rating		
	Current	Potential
Very energy efficient - lower running costs		
(92 plus) A		
(81-91) B		
(69-80) C	75	75
(55-68) D		
(39-54) E		
(21-38) F		
(1-20) G		
Not energy efficient - higher running costs		
England & Wales		
EU Directive 2002/91/EC		